

RECENTLY APPROVED DWELLING REF 22/00134/AS

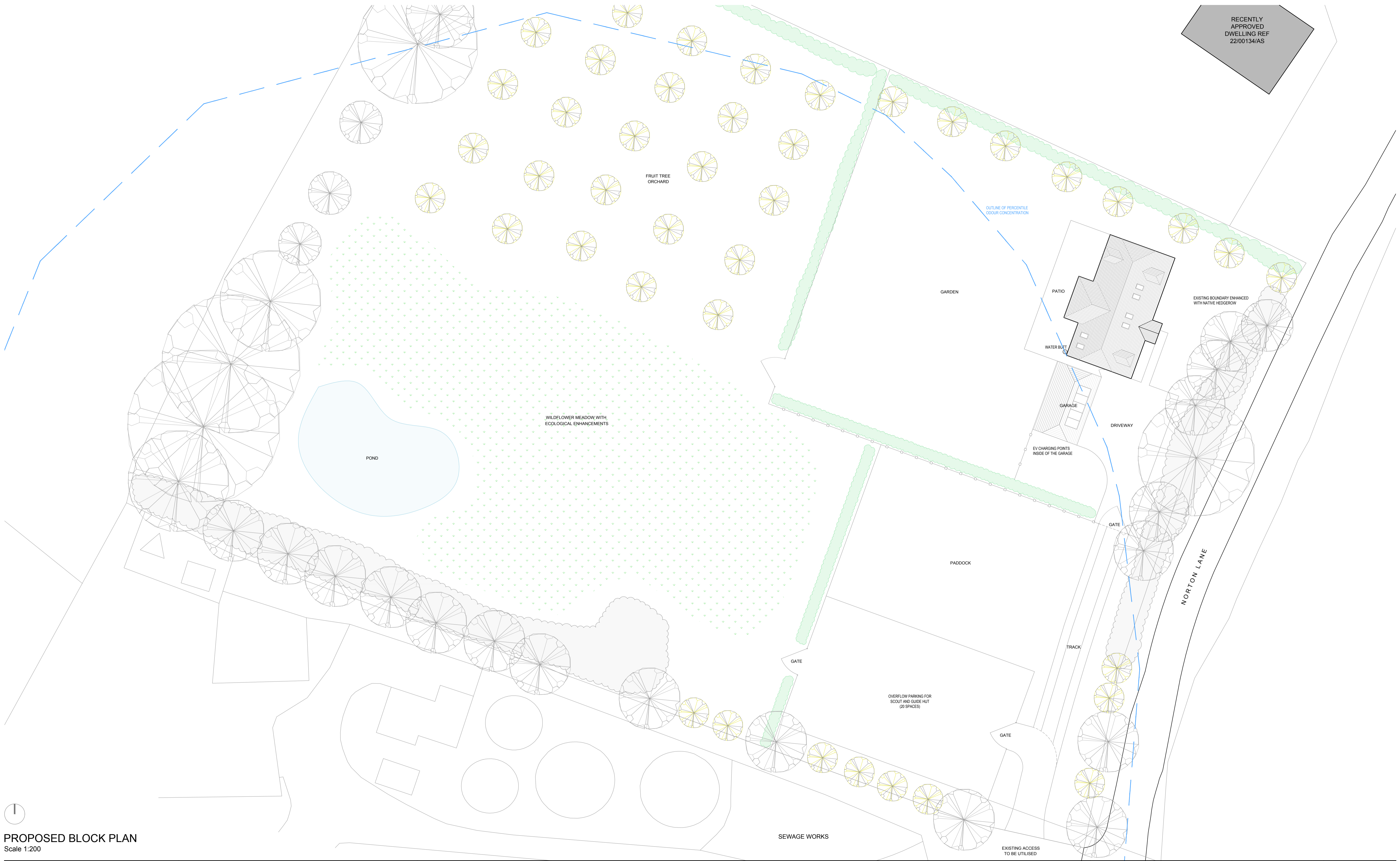

PROPOSED BLOCK PLAN

Scale 1:200

NOTES
 Do Not Scale (unless for the purposes of planning).
 Report all discrepancies, errors and omissions.
 Verify all dimensions on site before commencing any work on site or preparing shop drawings.
 All materials, components and workmanship are to comply with the relevant British Standards, Codes of Practice, and appropriate manufacturers recommendations that from time to time shall apply.
 For all specialist work, see relevant drawings.
 This drawing is copyright of Kent Design Studio Ltd

CDM 2015
 Under the CDM regulations 2015, the client will need to employ a principal designer and principal contractor to assist in the health and safety process and co-ordinate health and safety matters. Further advice with regards to the clients duties and the duties of the principal designer & principal contractor can be found on the Internet (such as CONIAC Industry Guidance & HSE website), or alternatively you should take advice from a suitably qualified company. This drawing, together with an asbestos survey or any other surveys and record drawings / information that the client has on the building or site such as service locations should be passed on to the contractor. Our brief does not extend to principal designer role, so the principal contractor will be responsible for developing health and safety file during construction and handing it over to the client as an as built health and safety file.



KENT DESIGN STUDIO
 W. WWW.KENTDESIGNSTUDIO.CO.UK
 T. 01880 230413
 E. INFO@KENTDESIGNSTUDIO.CO.UK

SCALE	DATE
AS NOTED AT A1	DEC 2025
STATUS	
PROPOSED	

PROJECT PROPOSED RESIDENTIAL DWELLING AT: LAND NORTH EAST OF SEWAGE WORKS, NORTON LANE, BETHERSDEN, ASHFORD, KENT	DESCRIPTION PROPOSED BLOCK PLAN
DRAWING NO 4218_03	DRAWN BY JE