

General Note:
 The Main Contractor and/or any Sub-Contractors are entirely responsible for taking and checking all levels, dimensions and materials - whether specified or otherwise implied - before, during and in completion of this project.
 All dimensions shown on drawings take precedence over scaled dimensions.
 ALL DIMENSIONS MUST BE CROSS CHECKED AGAINST ACTUAL SITE BEFORE COMMENCEMENT OF ANY WORKS.

AS PROPOSED

THE KING HOTEL, BIDDENDEN ROAD, TENTERDEN, KENT. TN30 6SX

BIODIVERSITY NET GAIN - PROPOSED BLOCK PLAN

Proposal: To build new single storey building for use as self-contained holiday accommodation ancillary to The King Hotel

Location: Land to the South East of Forge House, Biddenden Road, Tenterden TN30 6SX

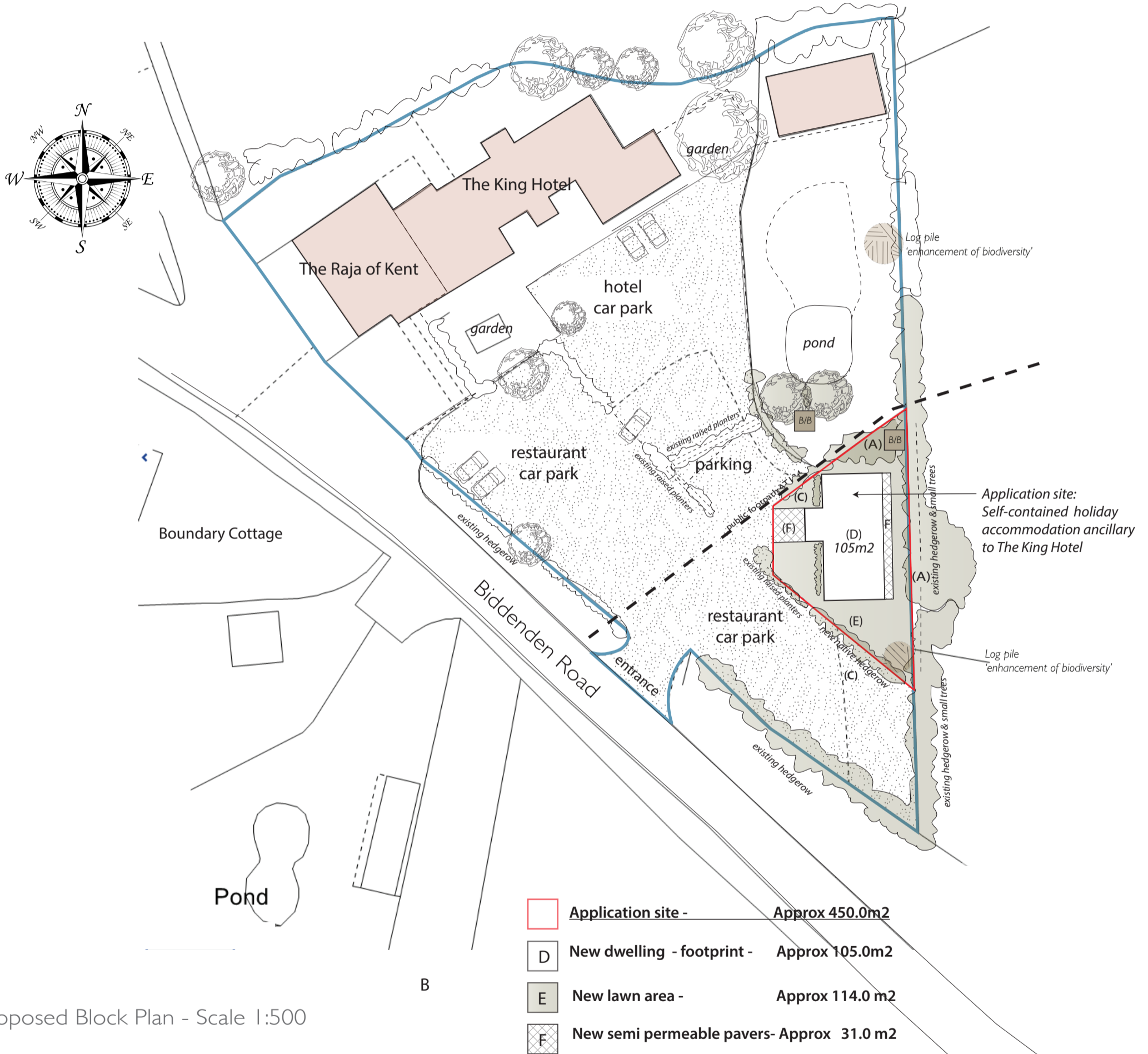

Proposed Block Plan - Scale 1:500

	Application site -	Approx 450.0m ²
	New dwelling - footprint -	Approx 105.0m ²
	New lawn area -	Approx 114.0 m ²
	New semi permeable pavers-	Approx 31.0 m ²

Net Gain Approx 114.0 m²
 plus

Plant new native hedgerow - Approx 20.0 m

Native Hedgerow And Small Trees 3m - 5m h
 Hawthorn - *Crataegus monogyna* 35%
 Acer campestre 35%,
 Hazel - *Corylus avellana* 15%,
 Blackthorn - *Prunus spinosa* 15%

Existing hedgerow & small trees to east boundary of application site
 Predominately hawthorn (*Crataegus monogyna*) & dogwood (*Cornus sanguinea*).
 Also blackthorn (*Prunus spinosa*), rose (*Rosa sp.*) and ivy (*Hedera helix*).

Approx area of hedgerow to the application land - 50 m² - length approx 41 m
TO NOTE; THE EXISTING BOUNDARY HEDGEROW WILL NOT BE AFFECTED BY THESE PROPOSALS

FOR PLANNING PURPOSES ONLY

Ref: Proposed Block Plan
 Date: October 2025
 Drw. No. OCT25/KH/PBP/BNG



Bird & Bat boxes

Log pile 'enhancement of biodiversity'