

Existing Floor Plans

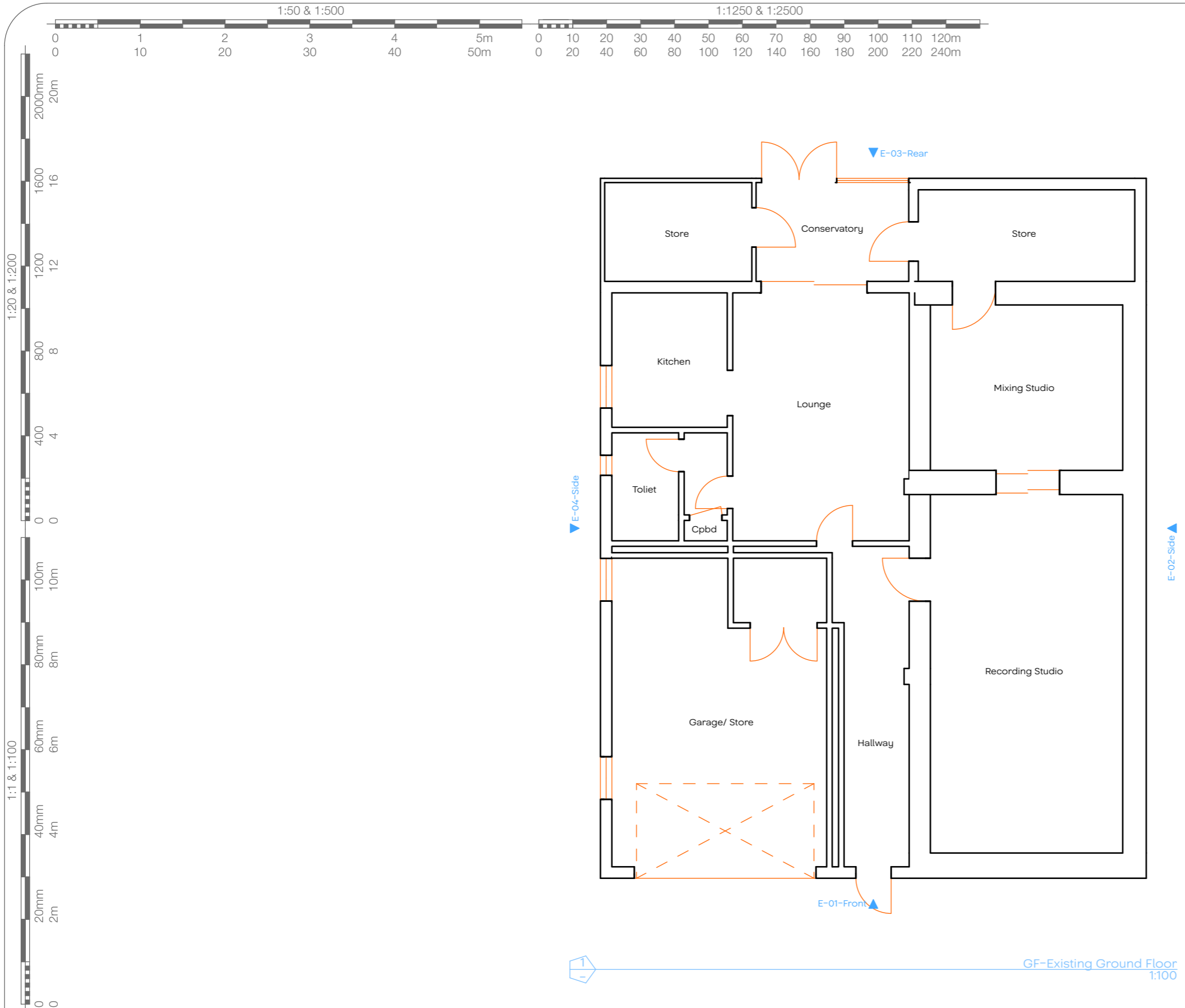
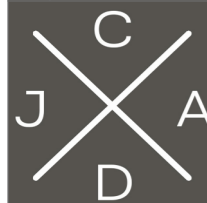

GF-Existing Ground Floor
1:100

JOHN CHILDS ARCHITECTURAL DESIGN
 www.johnchilds.com 01622 812868
 020 8179 1951

Address :- 247 Faversham Road, Ashford, Kent		Scale :- As Marked	Date :- April 2025	Drawing No. :- P.01	Revision Notes :-	RevID	ChID	Change Name	Date
Project :- Part change of use of outbuilding to residential annexe		Paper Size :- A3	Drawn by :- JLRC	Revision No :-					

The copyright in this plan shall be the absolute property of John Childs Architectural Design and shall not be reproduced either in whole or part without their expressed permission.
All measurements to be checked on site prior to any works undertaken